

H = 740,992 m
 T = 7,312 m
 f = 0,036 m
 km 0+030,633
 h TS = 381,249 m

km 0+000,000
 h TS = 382,520 m

H = -362,123 m
 T = 14,097 m
 f = -0,274 m
 km 0+062,420
 h TS = 380,557 m

H = 247,309 m
 T = 17,555 m
 f = 0,623 m
 km 0+151,595
 h TS = 371,674 m

H = -445,239 m
 T = 23,347 m
 f = -0,612 m
 km 0+192,497
 h TS = 373,406 m

H = 543,594 m
 T = 17,085 m
 f = 0,268 m
 km 0+267,853
 h TS = 368,695 m

km 0+332,517
 h TS = 369,496 m

H = 42,090 m
 T = 1,670 m
 f = 0,033 m
 km 0+322,690
 h TS = 368,713 m

H = -500,000 m
 T = 3,595 m
 f = -0,013 m
 km 0+425,543
 h TS = 369,045 m

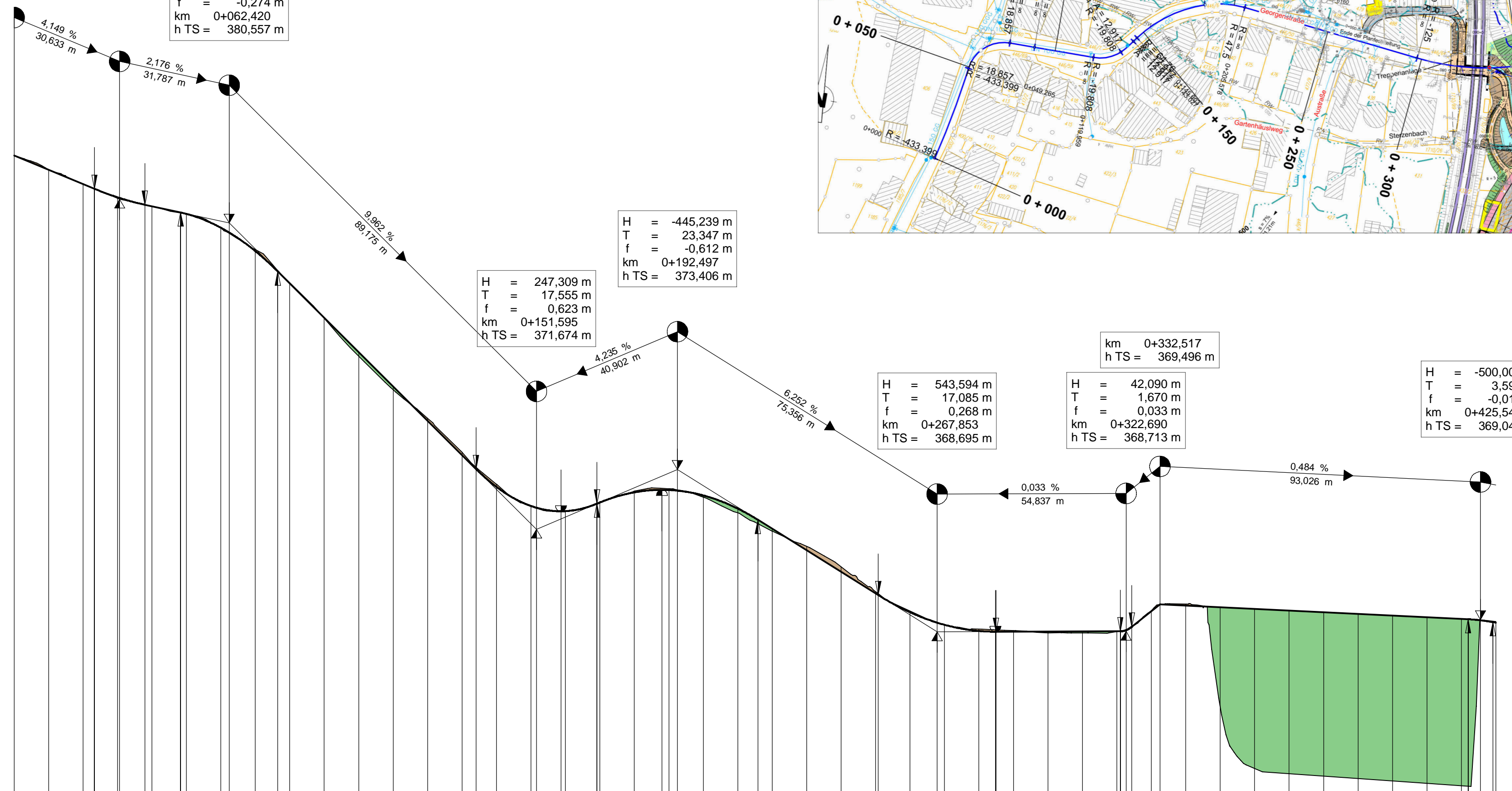
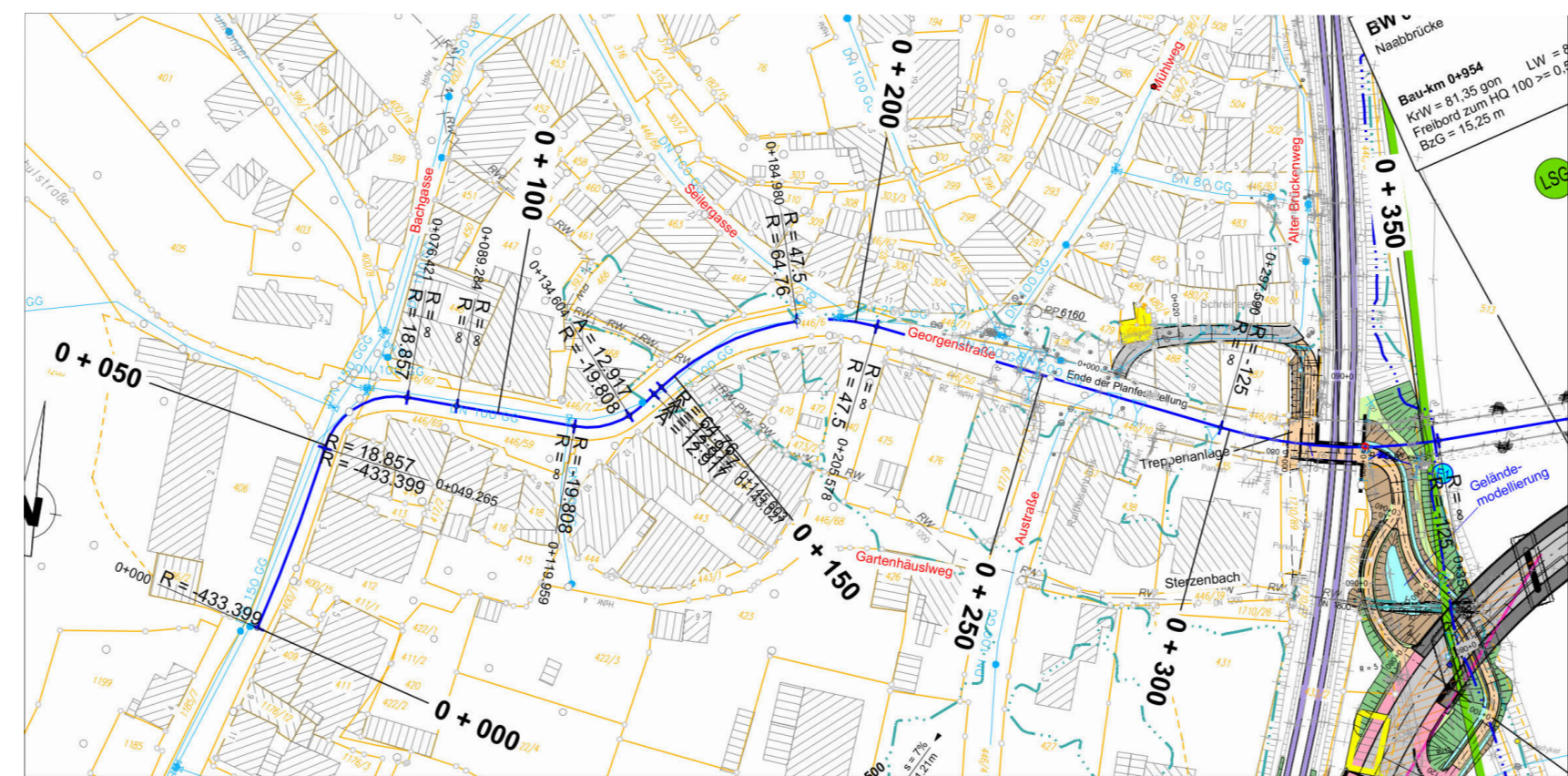

361,00 m ü. NN

Station	Geländehöhe	Gradientenhöhe
0,000	382,52	382,520
10,000	382,11	382,105
20,000	381,69	381,690
23,321	381,552	381,305
30,000	381,31	381,305
30,633	381,285	381,285
37,945	381,050	381,045
40,000	381,05	381,045
48,323	380,864	380,864
50,000	380,82	380,824
60,000	380,41	380,422
62,420	380,283	380,283
70,000	379,79	379,744
76,518	379,153	379,153
80,000	378,83	378,806
90,000	377,80	377,810
100,000	376,69	376,814
110,000	375,72	375,818
120,000	374,89	374,822
130,000	373,90	373,825
134,041	373,423	373,423
140,000	372,98	372,901
150,000	372,34	372,348
151,595	372,297	372,297
158,677	372,196	372,196
160,000	372,20	372,199
169,150	372,418	372,418
170,000	372,43	372,453
180,000	372,78	372,745
188,006	372,817	372,817
190,000	372,85	372,812
192,497	372,794	372,794
200,000	372,60	372,655
210,000	372,15	372,274
215,845	371,947	371,947
220,000	371,62	371,687
230,000	371,18	371,062
240,000	370,58	370,436
250,000	369,87	369,811
250,768	369,763	369,763
260,000	369,30	369,264
267,853	368,953	368,953
270,000	368,90	368,901
280,000	368,77	368,721
284,757	368,700	368,700
284,938	368,702	368,702
290,000	368,73	368,702
300,000	368,66	368,705
310,000	368,66	368,709
320,000	368,71	368,712
321,021	368,712	368,712
322,690	368,746	368,746
324,360	368,846	368,846
330,000	369,31	369,295
332,517	369,496	369,496
340,000	369,50	369,460
350,000	366,54	369,411
360,000	364,73	369,363
370,000	364,59	369,314
380,000	364,51	369,266
390,000	364,44	369,217
400,000	364,37	369,169
410,000	364,30	369,121
420,000	364,23	369,072
421,947	369,053	369,053
425,543	369,032	369,032
429,138	368,976	368,976
430,000	368,99	368,960

Bau-km 0+000

File: Höhenplan_Lageplan Georgenstrasse – Nullvariante.pdf

Rechtskurve
 Krümmungsband
 Maßstab 20/R (cm)
 Linkskurve

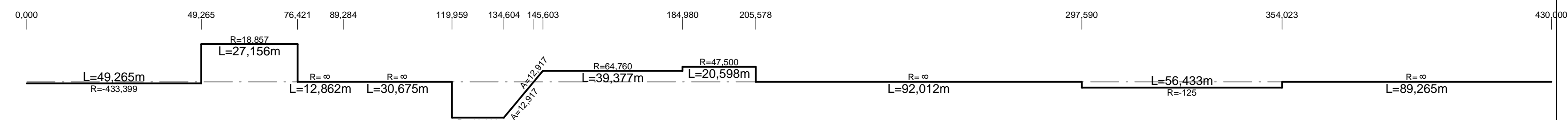

Straßenbauverwaltung Freistaat Bayern	
aufgestellt: Staatliches Bauamt Amberg-Weilburg	Unterlage:
Straße / Abschnittsnummer / Station:	Maßstab: 1 : 1000/100
PROJIS-Nr.:	Datum:
St 2040 Beseitigung des Bahnüberganges in Nabburg Höhenplan Georgenstrasse	